

CILINDROS NEUMATICOS

COMPACTOS

CIL.COMPACTO ISO21287 D.E. MAG



Referencia: **CDEM25-125KNF**

Descripción

Cilindro doble efecto, magnético, con las mismas prestaciones que un cilindro ISO6431 con dimensiones más reducidas, emplea las mismas fijaciones que los cilindros ISO 6431.

Características

| Referencia | Diámetro (mm) | Carrera (mm) | Fuerza empuje (N) | Fuerza tracción (N) |
|---------------|---------------|--------------|-------------------|---------------------|
| CDEM20-5KNF | 20 | 5 | 170 | 127 |
| CDEM20-10KNF | 20 | 10 | 170 | 127 |
| CDEM20-15KNF | 20 | 15 | 170 | 127 |
| CDEM20-20KNF | 20 | 20 | 170 | 127 |
| CDEM20-25KNF | 20 | 25 | 170 | 127 |
| CDEM20-30KNF | 20 | 30 | 170 | 127 |
| CDEM20-40KNF | 20 | 40 | 170 | 127 |
| CDEM20-50KNF | 20 | 50 | 170 | 127 |
| CDEM20-60KNF | 20 | 60 | 170 | 127 |
| CDEM20-80KNF | 20 | 80 | 170 | 127 |
| CDEM20-100KNF | 20 | 100 | 170 | 127 |
| CDEM20-125KNF | 20 | 125 | 170 | 127 |
| CDEM20-150KNF | 20 | 150 | 170 | 127 |
| CDEM25-5KNF | 25 | 5 | 265 | 222 |
| CDEM25-10KNF | 25 | 10 | 265 | 222 |
| CDEM25-15KNF | 25 | 15 | 265 | 222 |
| CDEM25-20KNF | 25 | 20 | 265 | 222 |
| CDEM25-25KNF | 25 | 25 | 265 | 222 |
| CDEM25-30KNF | 25 | 30 | 265 | 222 |
| CDEM25-40KNF | 25 | 40 | 265 | 222 |
| CDEM25-50KNF | 25 | 50 | 265 | 222 |
| CDEM25-60KNF | 25 | 60 | 265 | 222 |
| CDEM25-80KNF | 25 | 80 | 265 | 222 |
| CDEM25-100KNF | 25 | 100 | 265 | 222 |
| CDEM25-125KNF | 25 | 125 | 265 | 222 |
| CDEM25-150KNF | 25 | 150 | 265 | 222 |
| CDEM32-5KNF | 32 | 5 | 434 | 373 |
| CDEM32-10KNF | 32 | 10 | 434 | 373 |

| | | | | |
|---------------|----|-----|------|------|
| CDEM32-15KNF | 32 | 15 | 434 | 373 |
| CDEM32-20KNF | 32 | 20 | 434 | 373 |
| CDEM32-25KNF | 32 | 25 | 434 | 373 |
| CDEM32-30KNF | 32 | 30 | 434 | 373 |
| CDEM32-40KNF | 32 | 40 | 434 | 373 |
| CDEM32-50KNF | 32 | 50 | 434 | 373 |
| CDEM32-60KNF | 32 | 60 | 434 | 373 |
| CDEM32-80KNF | 32 | 80 | 434 | 373 |
| CDEM32-100KNF | 32 | 100 | 434 | 373 |
| CDEM32-125KNF | 32 | 125 | 434 | 373 |
| CDEM32-150KNF | 32 | 150 | 434 | 373 |
| CDEM32-200KNF | 32 | 200 | 434 | 373 |
| CDEM32-250KNF | 32 | 250 | 434 | 373 |
| CDEM32-300KNF | 32 | 300 | 434 | 373 |
| CDEM40-5KNF | 40 | 5 | 678 | 617 |
| CDEM40-10KNF | 40 | 10 | 678 | 617 |
| CDEM40-15KNF | 40 | 15 | 678 | 617 |
| CDEM40-20KNF | 40 | 20 | 678 | 617 |
| CDEM40-25KNF | 40 | 25 | 678 | 617 |
| CDEM40-30KNF | 40 | 30 | 678 | 617 |
| CDEM40-40KNF | 40 | 40 | 678 | 617 |
| CDEM40-50KNF | 40 | 50 | 678 | 617 |
| CDEM40-60KNF | 40 | 60 | 678 | 617 |
| CDEM40-80KNF | 40 | 80 | 678 | 617 |
| CDEM40-100KNF | 40 | 100 | 678 | 617 |
| CDEM40-125KNF | 40 | 125 | 678 | 617 |
| CDEM40-150KNF | 40 | 150 | 678 | 617 |
| CDEM40-200KNF | 40 | 200 | 678 | 617 |
| CDEM40-250KNF | 40 | 250 | 678 | 617 |
| CDEM40-300KNF | 40 | 300 | 678 | 617 |
| CDEM50-5KNF | 50 | 5 | 1060 | 951 |
| CDEM50-10KNF | 50 | 10 | 1060 | 951 |
| CDEM50-15KNF | 50 | 15 | 1060 | 951 |
| CDEM50-20KNF | 50 | 20 | 1060 | 951 |
| CDEM50-25KNF | 50 | 25 | 1060 | 951 |
| CDEM50-30KNF | 50 | 30 | 1060 | 951 |
| CDEM50-40KNF | 50 | 40 | 1060 | 951 |
| CDEM50-50KNF | 50 | 50 | 1060 | 951 |
| CDEM50-60KNF | 50 | 60 | 1060 | 951 |
| CDEM50-80KNF | 50 | 80 | 1060 | 951 |
| CDEM50-100KNF | 50 | 100 | 1060 | 951 |
| CDEM50-125KNF | 50 | 125 | 1060 | 951 |
| CDEM50-150KNF | 50 | 150 | 1060 | 951 |
| CDEM50-200KNF | 50 | 200 | 1060 | 951 |
| CDEM50-250KNF | 50 | 250 | 1060 | 951 |
| CDEM50-300KNF | 50 | 300 | 1060 | 951 |
| CDEM63-5KNF | 63 | 5 | 1682 | 1573 |
| CDEM63-10KNF | 63 | 10 | 1682 | 1573 |
| CDEM63-15KNF | 63 | 15 | 1682 | 1573 |
| CDEM63-20KNF | 63 | 20 | 1682 | 1573 |
| CDEM63-25KNF | 63 | 25 | 1682 | 1573 |
| CDEM63-30KNF | 63 | 30 | 1682 | 1573 |
| CDEM63-40KNF | 63 | 40 | 1682 | 1573 |
| CDEM63-50KNF | 63 | 50 | 1682 | 1573 |
| CDEM63-60KNF | 63 | 60 | 1682 | 1573 |
| CDEM63-80KNF | 63 | 80 | 1682 | 1573 |
| CDEM63-100KNF | 63 | 100 | 1682 | 1573 |
| CDEM63-125KNF | 63 | 125 | 1682 | 1573 |
| CDEM63-150KNF | 63 | 150 | 1682 | 1573 |

| | | | | |
|----------------|-----|-----|------|------|
| CDEM63-200KNF | 63 | 200 | 1682 | 1573 |
| CDEM63-250KNF | 63 | 250 | 1682 | 1573 |
| CDEM63-300KNF | 63 | 300 | 1682 | 1573 |
| CDEM80-5KNF | 80 | 5 | 2713 | 2543 |
| CDEM80-10KNF | 80 | 10 | 2713 | 2543 |
| CDEM80-15KNF | 80 | 15 | 2713 | 2543 |
| CDEM80-20KNF | 80 | 20 | 2713 | 2543 |
| CDEM80-25KNF | 80 | 25 | 2713 | 2543 |
| CDEM80-30KNF | 80 | 30 | 2713 | 2543 |
| CDEM80-40KNF | 80 | 40 | 2713 | 2543 |
| CDEM80-50KNF | 80 | 50 | 2713 | 2543 |
| CDEM80-60KNF | 80 | 60 | 2713 | 2543 |
| CDEM80-80KNF | 80 | 80 | 2713 | 2543 |
| CDEM80-100KNF | 80 | 100 | 2713 | 2543 |
| CDEM80-125KNF | 80 | 125 | 2713 | 2543 |
| CDEM80-150KNF | 80 | 150 | 2713 | 2543 |
| CDEM80-200KNF | 80 | 200 | 2713 | 2543 |
| CDEM80-250KNF | 80 | 250 | 2713 | 2543 |
| CDEM80-300KNF | 80 | 300 | 2713 | 2543 |
| CDEM80-350KNF | 80 | 350 | 2713 | 2543 |
| CDEM80-400KNF | 80 | 400 | 2713 | 2543 |
| CDEM100-5KNF | 100 | 5 | 4239 | 3974 |
| CDEM100-10KNF | 100 | 10 | 4239 | 3974 |
| CDEM100-15KNF | 100 | 15 | 4239 | 3974 |
| CDEM100-20KNF | 100 | 20 | 4239 | 3974 |
| CDEM100-25KNF | 100 | 25 | 4239 | 3974 |
| CDEM100-30KNF | 100 | 30 | 4239 | 3974 |
| CDEM100-40KNF | 100 | 40 | 4239 | 3974 |
| CDEM100-50KNF | 100 | 50 | 4239 | 3974 |
| CDEM100-60KNF | 100 | 60 | 4239 | 3974 |
| CDEM100-80KNF | 100 | 80 | 4239 | 3974 |
| CDEM100-100KNF | 100 | 100 | 4239 | 3974 |
| CDEM100-125KNF | 100 | 125 | 4239 | 3974 |
| CDEM100-150KNF | 100 | 150 | 4239 | 3974 |
| CDEM100-200KNF | 100 | 200 | 4239 | 3974 |
| CDEM100-250KNF | 100 | 250 | 4239 | 3974 |
| CDEM100-300KNF | 100 | 300 | 4239 | 3974 |
| CDEM100-350KNF | 100 | 350 | 4239 | 3974 |
| CDEM100-400KNF | 100 | 400 | 4239 | 3974 |

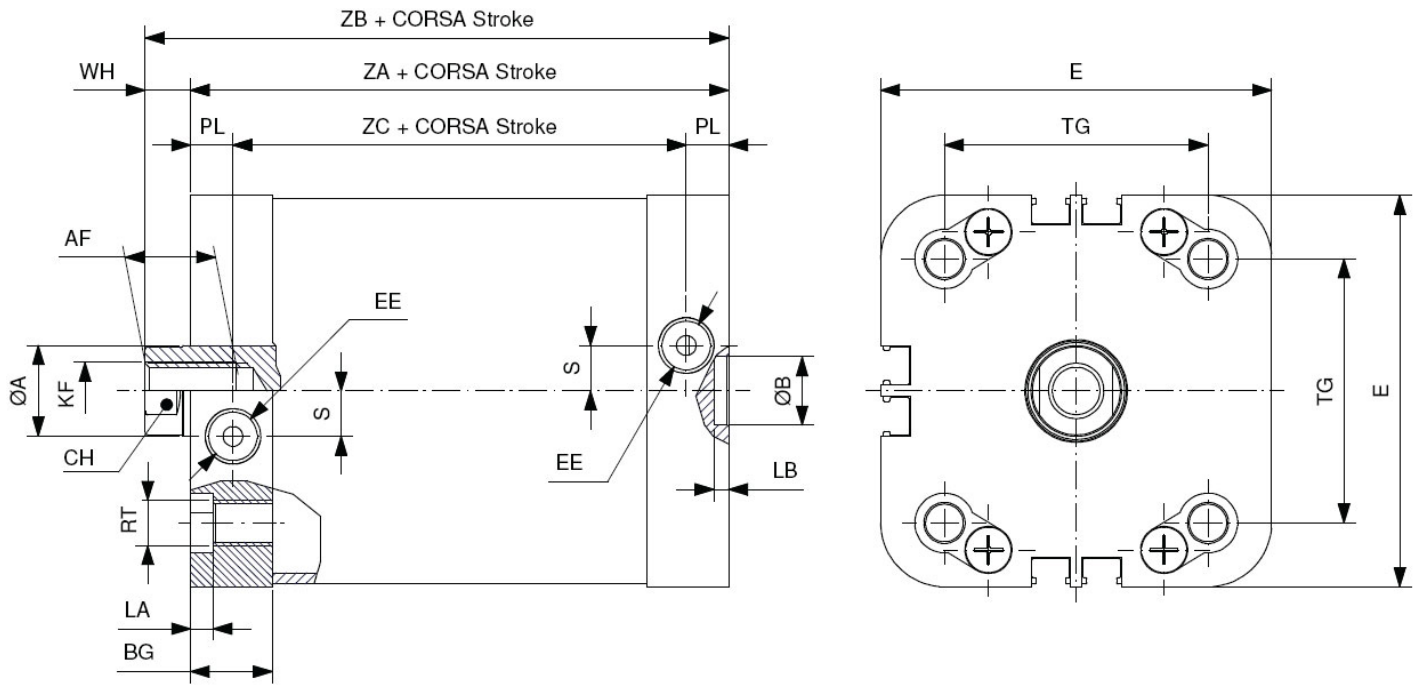

| ø mm | ØA | CH | AF | WH | ZA | ZB | ZC | KF | EE | BG | TG | E | RT | LA | PL | ØB | LB | S |
|------|----|----|----|----|-----|----|------|----------|--------|-------|------|-------|---------|-----|------|----|-----|------|
| 20 | 10 | 9 | 10 | 6 | 37 | 43 | 23 | M6x1 | M5x0.8 | 14,25 | 22 | 36 | M5x0.8 | 3 | 7 | 9 | 2,1 | 2,5 |
| 25 | 10 | 9 | 10 | 6 | 39 | 45 | 25 | M6x1 | M5x0.8 | 14 | 26 | 39,5 | M5x0.8 | 3 | 7 | 9 | 2,1 | 2,5 |
| 32 | 12 | 10 | 12 | 7 | 44 | 51 | 28,5 | M8x1,25 | 1/8"G | 15,5 | 32,5 | 49,5 | M6x1 | 3,5 | 7,75 | 9 | 2,1 | 6 |
| 40 | 12 | 10 | 12 | 7 | 45 | 52 | 29,5 | M8x1,25 | 1/8"G | 15,5 | 38 | 54 | M6x1 | 3,5 | 7,75 | 9 | 2,1 | 8 |
| 50 | 16 | 13 | 16 | 8 | 45 | 53 | 29,5 | M10x1,5 | 1/8"G | 14,5 | 46,5 | 69 | M8x1,25 | 4 | 7,5 | 12 | 2,6 | 8 |
| 63 | 16 | 13 | 16 | 8 | 449 | 57 | 33,5 | M10x1,5 | 1/8"G | 15,5 | 56,5 | 79 | M8x1,25 | 4 | 7,75 | 12 | 2,6 | 11,5 |
| 80 | 20 | 17 | 20 | 10 | 54 | 64 | 36,5 | M12x1,75 | 1/8"G | 17,5 | 72 | 94,5 | M10x1,5 | 5 | 8,75 | 12 | 2,6 | 11,5 |
| 100 | 25 | 21 | 20 | 10 | 67 | 77 | 46 | M12x1,75 | 1/8"G | 21 | 89 | 114,5 | M10x1,5 | 5 | 10,5 | 12 | 2,6 | 20 |