

CILINDROS NEUMATICOS

COMPACTOS

CIL.COMPACTO ISO21287 D.E. MAG



Referencia: **CDEM25-150KNF**

Descripción

Cilindro doble efecto, magnético, con las mismas prestaciones que un cilindro ISO6431 con dimensiones más reducidas, emplea las mismas fijaciones que los cilindros ISO 6431.

Características

Referencia	Diámetro (mm)	Carrera (mm)	Fuerza empuje (N)	Fuerza tracción (N)
CDEM20-5KNF	20	5	170	127
CDEM20-10KNF	20	10	170	127
CDEM20-15KNF	20	15	170	127
CDEM20-20KNF	20	20	170	127
CDEM20-25KNF	20	25	170	127
CDEM20-30KNF	20	30	170	127
CDEM20-40KNF	20	40	170	127
CDEM20-50KNF	20	50	170	127
CDEM20-60KNF	20	60	170	127
CDEM20-80KNF	20	80	170	127
CDEM20-100KNF	20	100	170	127
CDEM20-125KNF	20	125	170	127
CDEM20-150KNF	20	150	170	127
CDEM25-5KNF	25	5	265	222
CDEM25-10KNF	25	10	265	222
CDEM25-15KNF	25	15	265	222
CDEM25-20KNF	25	20	265	222
CDEM25-25KNF	25	25	265	222
CDEM25-30KNF	25	30	265	222
CDEM25-40KNF	25	40	265	222
CDEM25-50KNF	25	50	265	222
CDEM25-60KNF	25	60	265	222
CDEM25-80KNF	25	80	265	222
CDEM25-100KNF	25	100	265	222
CDEM25-125KNF	25	125	265	222
CDEM25-150KNF	25	150	265	222
CDEM32-5KNF	32	5	434	373
CDEM32-10KNF	32	10	434	373

CDEM32-15KNF	32	15	434	373
CDEM32-20KNF	32	20	434	373
CDEM32-25KNF	32	25	434	373
CDEM32-30KNF	32	30	434	373
CDEM32-40KNF	32	40	434	373
CDEM32-50KNF	32	50	434	373
CDEM32-60KNF	32	60	434	373
CDEM32-80KNF	32	80	434	373
CDEM32-100KNF	32	100	434	373
CDEM32-125KNF	32	125	434	373
CDEM32-150KNF	32	150	434	373
CDEM32-200KNF	32	200	434	373
CDEM32-250KNF	32	250	434	373
CDEM32-300KNF	32	300	434	373
CDEM40-5KNF	40	5	678	617
CDEM40-10KNF	40	10	678	617
CDEM40-15KNF	40	15	678	617
CDEM40-20KNF	40	20	678	617
CDEM40-25KNF	40	25	678	617
CDEM40-30KNF	40	30	678	617
CDEM40-40KNF	40	40	678	617
CDEM40-50KNF	40	50	678	617
CDEM40-60KNF	40	60	678	617
CDEM40-80KNF	40	80	678	617
CDEM40-100KNF	40	100	678	617
CDEM40-125KNF	40	125	678	617
CDEM40-150KNF	40	150	678	617
CDEM40-200KNF	40	200	678	617
CDEM40-250KNF	40	250	678	617
CDEM40-300KNF	40	300	678	617
CDEM50-5KNF	50	5	1060	951
CDEM50-10KNF	50	10	1060	951
CDEM50-15KNF	50	15	1060	951
CDEM50-20KNF	50	20	1060	951
CDEM50-25KNF	50	25	1060	951
CDEM50-30KNF	50	30	1060	951
CDEM50-40KNF	50	40	1060	951
CDEM50-50KNF	50	50	1060	951
CDEM50-60KNF	50	60	1060	951
CDEM50-80KNF	50	80	1060	951
CDEM50-100KNF	50	100	1060	951
CDEM50-125KNF	50	125	1060	951
CDEM50-150KNF	50	150	1060	951
CDEM50-200KNF	50	200	1060	951
CDEM50-250KNF	50	250	1060	951
CDEM50-300KNF	50	300	1060	951
CDEM63-5KNF	63	5	1682	1573
CDEM63-10KNF	63	10	1682	1573
CDEM63-15KNF	63	15	1682	1573
CDEM63-20KNF	63	20	1682	1573
CDEM63-25KNF	63	25	1682	1573
CDEM63-30KNF	63	30	1682	1573
CDEM63-40KNF	63	40	1682	1573
CDEM63-50KNF	63	50	1682	1573
CDEM63-60KNF	63	60	1682	1573
CDEM63-80KNF	63	80	1682	1573
CDEM63-100KNF	63	100	1682	1573
CDEM63-125KNF	63	125	1682	1573
CDEM63-150KNF	63	150	1682	1573

CDEM63-200KNF	63	200	1682	1573
CDEM63-250KNF	63	250	1682	1573
CDEM63-300KNF	63	300	1682	1573
CDEM80-5KNF	80	5	2713	2543
CDEM80-10KNF	80	10	2713	2543
CDEM80-15KNF	80	15	2713	2543
CDEM80-20KNF	80	20	2713	2543
CDEM80-25KNF	80	25	2713	2543
CDEM80-30KNF	80	30	2713	2543
CDEM80-40KNF	80	40	2713	2543
CDEM80-50KNF	80	50	2713	2543
CDEM80-60KNF	80	60	2713	2543
CDEM80-80KNF	80	80	2713	2543
CDEM80-100KNF	80	100	2713	2543
CDEM80-125KNF	80	125	2713	2543
CDEM80-150KNF	80	150	2713	2543
CDEM80-200KNF	80	200	2713	2543
CDEM80-250KNF	80	250	2713	2543
CDEM80-300KNF	80	300	2713	2543
CDEM80-350KNF	80	350	2713	2543
CDEM80-400KNF	80	400	2713	2543
CDEM100-5KNF	100	5	4239	3974
CDEM100-10KNF	100	10	4239	3974
CDEM100-15KNF	100	15	4239	3974
CDEM100-20KNF	100	20	4239	3974
CDEM100-25KNF	100	25	4239	3974
CDEM100-30KNF	100	30	4239	3974
CDEM100-40KNF	100	40	4239	3974
CDEM100-50KNF	100	50	4239	3974
CDEM100-60KNF	100	60	4239	3974
CDEM100-80KNF	100	80	4239	3974
CDEM100-100KNF	100	100	4239	3974
CDEM100-125KNF	100	125	4239	3974
CDEM100-150KNF	100	150	4239	3974
CDEM100-200KNF	100	200	4239	3974
CDEM100-250KNF	100	250	4239	3974
CDEM100-300KNF	100	300	4239	3974
CDEM100-350KNF	100	350	4239	3974
CDEM100-400KNF	100	400	4239	3974

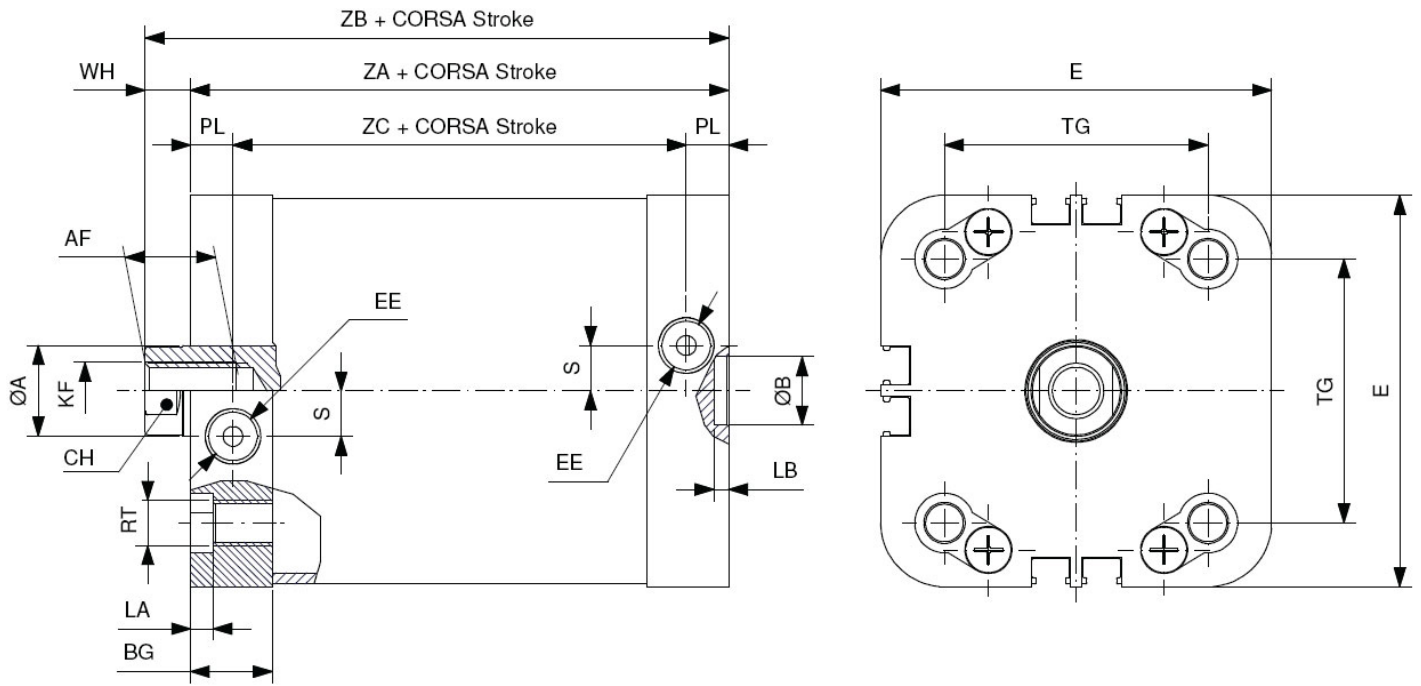

ø mm	ØA	CH	AF	WH	ZA	ZB	ZC	KF	EE	BG	TG	E	RT	LA	PL	ØB	LB	S
20	10	9	10	6	37	43	23	M6x1	M5x0.8	14,25	22	36	M5x0.8	3	7	9	2,1	2,5
25	10	9	10	6	39	45	25	M6x1	M5x0.8	14	26	39,5	M5x0.8	3	7	9	2,1	2,5
32	12	10	12	7	44	51	28,5	M8x1,25	1/8"G	15,5	32,5	49,5	M6x1	3,5	7,75	9	2,1	6
40	12	10	12	7	45	52	29,5	M8x1,25	1/8"G	15,5	38	54	M6x1	3,5	7,75	9	2,1	8
50	16	13	16	8	45	53	29,5	M10x1,5	1/8"G	14,5	46,5	69	M8x1,25	4	7,5	12	2,6	8
63	16	13	16	8	449	57	33,5	M10x1,5	1/8"G	15,5	56,5	79	M8x1,25	4	7,75	12	2,6	11,5
80	20	17	20	10	54	64	36,5	M12x1,75	1/8"G	17,5	72	94,5	M10x1,5	5	8,75	12	2,6	11,5
100	25	21	20	10	67	77	46	M12x1,75	1/8"G	21	89	114,5	M10x1,5	5	10,5	12	2,6	20