

# CILINDROS NEUMATICOS

## COMPACTOS

CIL.COMPACTO ISO21287 D.E. MAG



Referencia: **CDEM25-25KNF**

### Descripción

Cilindro doble efecto, magnético, con las mismas prestaciones que un cilindro ISO6431 con dimensiones más reducidas, emplea las mismas fijaciones que los cilindros ISO 6431.

### Características

Referencia	Diámetro (mm)	Carrera (mm)	Fuerza empuje (N)	Fuerza tracción (N)
CDEM20-5KNF	20	5	170	127
CDEM20-10KNF	20	10	170	127
CDEM20-15KNF	20	15	170	127
CDEM20-20KNF	20	20	170	127
CDEM20-25KNF	20	25	170	127
CDEM20-30KNF	20	30	170	127
CDEM20-40KNF	20	40	170	127
CDEM20-50KNF	20	50	170	127
CDEM20-60KNF	20	60	170	127
CDEM20-80KNF	20	80	170	127
CDEM20-100KNF	20	100	170	127
CDEM20-125KNF	20	125	170	127
CDEM20-150KNF	20	150	170	127
CDEM25-5KNF	25	5	265	222
CDEM25-10KNF	25	10	265	222
CDEM25-15KNF	25	15	265	222
CDEM25-20KNF	25	20	265	222
CDEM25-25KNF	25	25	265	222
CDEM25-30KNF	25	30	265	222
CDEM25-40KNF	25	40	265	222
CDEM25-50KNF	25	50	265	222
CDEM25-60KNF	25	60	265	222
CDEM25-80KNF	25	80	265	222
CDEM25-100KNF	25	100	265	222
CDEM25-125KNF	25	125	265	222
CDEM25-150KNF	25	150	265	222
CDEM32-5KNF	32	5	434	373
CDEM32-10KNF	32	10	434	373

CDEM32-15KNF	32	15	434	373
CDEM32-20KNF	32	20	434	373
CDEM32-25KNF	32	25	434	373
CDEM32-30KNF	32	30	434	373
CDEM32-40KNF	32	40	434	373
CDEM32-50KNF	32	50	434	373
CDEM32-60KNF	32	60	434	373
CDEM32-80KNF	32	80	434	373
CDEM32-100KNF	32	100	434	373
CDEM32-125KNF	32	125	434	373
CDEM32-150KNF	32	150	434	373
CDEM32-200KNF	32	200	434	373
CDEM32-250KNF	32	250	434	373
CDEM32-300KNF	32	300	434	373
CDEM40-5KNF	40	5	678	617
CDEM40-10KNF	40	10	678	617
CDEM40-15KNF	40	15	678	617
CDEM40-20KNF	40	20	678	617
CDEM40-25KNF	40	25	678	617
CDEM40-30KNF	40	30	678	617
CDEM40-40KNF	40	40	678	617
CDEM40-50KNF	40	50	678	617
CDEM40-60KNF	40	60	678	617
CDEM40-80KNF	40	80	678	617
CDEM40-100KNF	40	100	678	617
CDEM40-125KNF	40	125	678	617
CDEM40-150KNF	40	150	678	617
CDEM40-200KNF	40	200	678	617
CDEM40-250KNF	40	250	678	617
CDEM40-300KNF	40	300	678	617
CDEM50-5KNF	50	5	1060	951
CDEM50-10KNF	50	10	1060	951
CDEM50-15KNF	50	15	1060	951
CDEM50-20KNF	50	20	1060	951
CDEM50-25KNF	50	25	1060	951
CDEM50-30KNF	50	30	1060	951
CDEM50-40KNF	50	40	1060	951
CDEM50-50KNF	50	50	1060	951
CDEM50-60KNF	50	60	1060	951
CDEM50-80KNF	50	80	1060	951
CDEM50-100KNF	50	100	1060	951
CDEM50-125KNF	50	125	1060	951
CDEM50-150KNF	50	150	1060	951
CDEM50-200KNF	50	200	1060	951
CDEM50-250KNF	50	250	1060	951
CDEM50-300KNF	50	300	1060	951
CDEM63-5KNF	63	5	1682	1573
CDEM63-10KNF	63	10	1682	1573
CDEM63-15KNF	63	15	1682	1573
CDEM63-20KNF	63	20	1682	1573
CDEM63-25KNF	63	25	1682	1573
CDEM63-30KNF	63	30	1682	1573
CDEM63-40KNF	63	40	1682	1573
CDEM63-50KNF	63	50	1682	1573
CDEM63-60KNF	63	60	1682	1573
CDEM63-80KNF	63	80	1682	1573
CDEM63-100KNF	63	100	1682	1573
CDEM63-125KNF	63	125	1682	1573
CDEM63-150KNF	63	150	1682	1573

CDEM63-200KNF	63	200	1682	1573
CDEM63-250KNF	63	250	1682	1573
CDEM63-300KNF	63	300	1682	1573
CDEM80-5KNF	80	5	2713	2543
CDEM80-10KNF	80	10	2713	2543
CDEM80-15KNF	80	15	2713	2543
CDEM80-20KNF	80	20	2713	2543
CDEM80-25KNF	80	25	2713	2543
CDEM80-30KNF	80	30	2713	2543
CDEM80-40KNF	80	40	2713	2543
CDEM80-50KNF	80	50	2713	2543
CDEM80-60KNF	80	60	2713	2543
CDEM80-80KNF	80	80	2713	2543
CDEM80-100KNF	80	100	2713	2543
CDEM80-125KNF	80	125	2713	2543
CDEM80-150KNF	80	150	2713	2543
CDEM80-200KNF	80	200	2713	2543
CDEM80-250KNF	80	250	2713	2543
CDEM80-300KNF	80	300	2713	2543
CDEM80-350KNF	80	350	2713	2543
CDEM80-400KNF	80	400	2713	2543
CDEM100-5KNF	100	5	4239	3974
CDEM100-10KNF	100	10	4239	3974
CDEM100-15KNF	100	15	4239	3974
CDEM100-20KNF	100	20	4239	3974
CDEM100-25KNF	100	25	4239	3974
CDEM100-30KNF	100	30	4239	3974
CDEM100-40KNF	100	40	4239	3974
CDEM100-50KNF	100	50	4239	3974
CDEM100-60KNF	100	60	4239	3974
CDEM100-80KNF	100	80	4239	3974
CDEM100-100KNF	100	100	4239	3974
CDEM100-125KNF	100	125	4239	3974
CDEM100-150KNF	100	150	4239	3974
CDEM100-200KNF	100	200	4239	3974
CDEM100-250KNF	100	250	4239	3974
CDEM100-300KNF	100	300	4239	3974
CDEM100-350KNF	100	350	4239	3974
CDEM100-400KNF	100	400	4239	3974

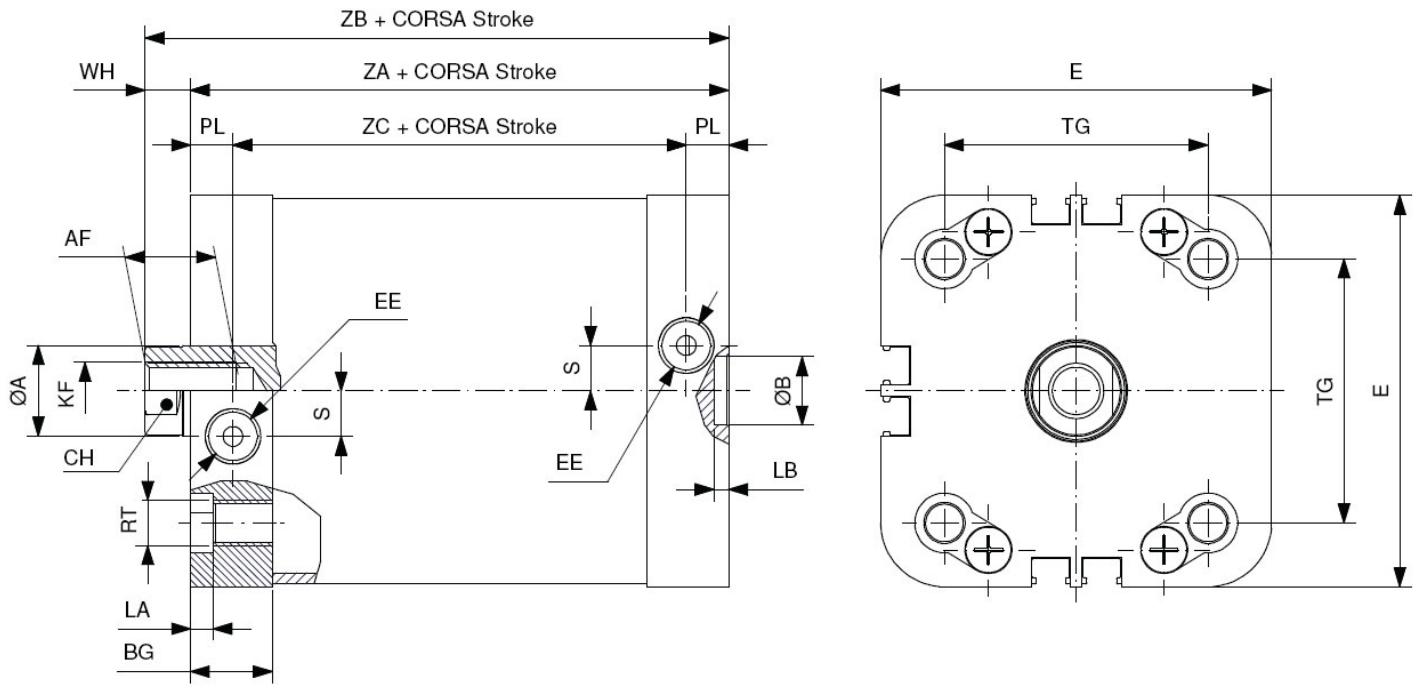

ø mm	ØA	CH	AF	WH	ZA	ZB	ZC	KF	EE	BG	TG	E	RT	LA	PL	ØB	LB	S
20	10	9	10	6	37	43	23	M6x1	M5x0.8	14,25	22	36	M5x0.8	3	7	9	2,1	2,5
25	10	9	10	6	39	45	25	M6x1	M5x0.8	14	26	39,5	M5x0.8	3	7	9	2,1	2,5
32	12	10	12	7	44	51	28,5	M8x1,25	1/8"G	15,5	32,5	49,5	M6x1	3,5	7,75	9	2,1	6
40	12	10	12	7	45	52	29,5	M8x1,25	1/8"G	15,5	38	54	M6x1	3,5	7,75	9	2,1	8
50	16	13	16	8	45	53	29,5	M10x1,5	1/8"G	14,5	46,5	69	M8x1,25	4	7,5	12	2,6	8
63	16	13	16	8	449	57	33,5	M10x1,5	1/8"G	15,5	56,5	79	M8x1,25	4	7,75	12	2,6	11,5
80	20	17	20	10	54	64	36,5	M12x1,75	1/8"G	17,5	72	94,5	M10x1,5	5	8,75	12	2,6	11,5
100	25	21	20	10	67	77	46	M12x1,75	1/8"G	21	89	114,5	M10x1,5	5	10,5	12	2,6	20